

Baker Commodities – LA Division
Figure of Facility Identifying Key Features

November 2023

KEY NOTES (THESE NOTES APPLY TO THIS SHEET ONLY)
ALL ITEMS ARE CONSIDERED NEW UNLESS NOTED OTHERWISE

1	EXISTING MAIN OFFICE BUILDING	6,222 SF
2	EXISTING TRUCK SCALE	770 SF
3	EXISTING LABORATORY BUILDING	2,032 SF
4	EXISTING MEAT MEAL BUILDING	4,065 SF
5	EXISTING GARAGE BUILDING	6,579 SF
6	EXISTING NEW CONSTRUCTION AND MAINTENANCE SHOP	9,009 SF
7	EXISTING MAINTENANCE OFFICE	290 SF
8	EXISTING REFINERY BUILDING	7,626 SF
9	EXISTING OFFICE AND LUNCH ROOM	1,371 SF
10	NEW ENGINEERING OFFICE	672 SF
11	EXISTING P-15 PLANT BUILDING	4,179 SF
12	EXISTING MAIN PLANT BUILDING	4,982 SF
13	EXISTING BOILER BUILDING	4,032 SF
14	RAW MATERIAL PIT ENCLOSURE	5,775 SF
15	WASTE WATER TREATMENT PLANT	14,200 SF

REV	DATE	DESCRIPTION
1		
2		
3		
4		
5		
6		
7		

REV	DATE	DESCRIPTION
1		
2		
3		
4		
5		
6		
7		

PROJECT: **PROPOSED ENCLOSURE**
4020 BANDINI BOULEVARD, LOS ANGELES, CALIFORNIA 90023

DRAWING TITLE: **SITE PLAN**

Baker Commodities, Inc.
LOS ANGELES DIVISION
4020 Bandini Boulevard
Los Angeles, California 90023

DRAWN BY: **VMDM**
DATE: **10.27.23**
SCALE: **AS SHOWN**
JOB NUMBER: **--**
PROJECT NUMBER:
DRAWING NUMBER: **AS1.2**

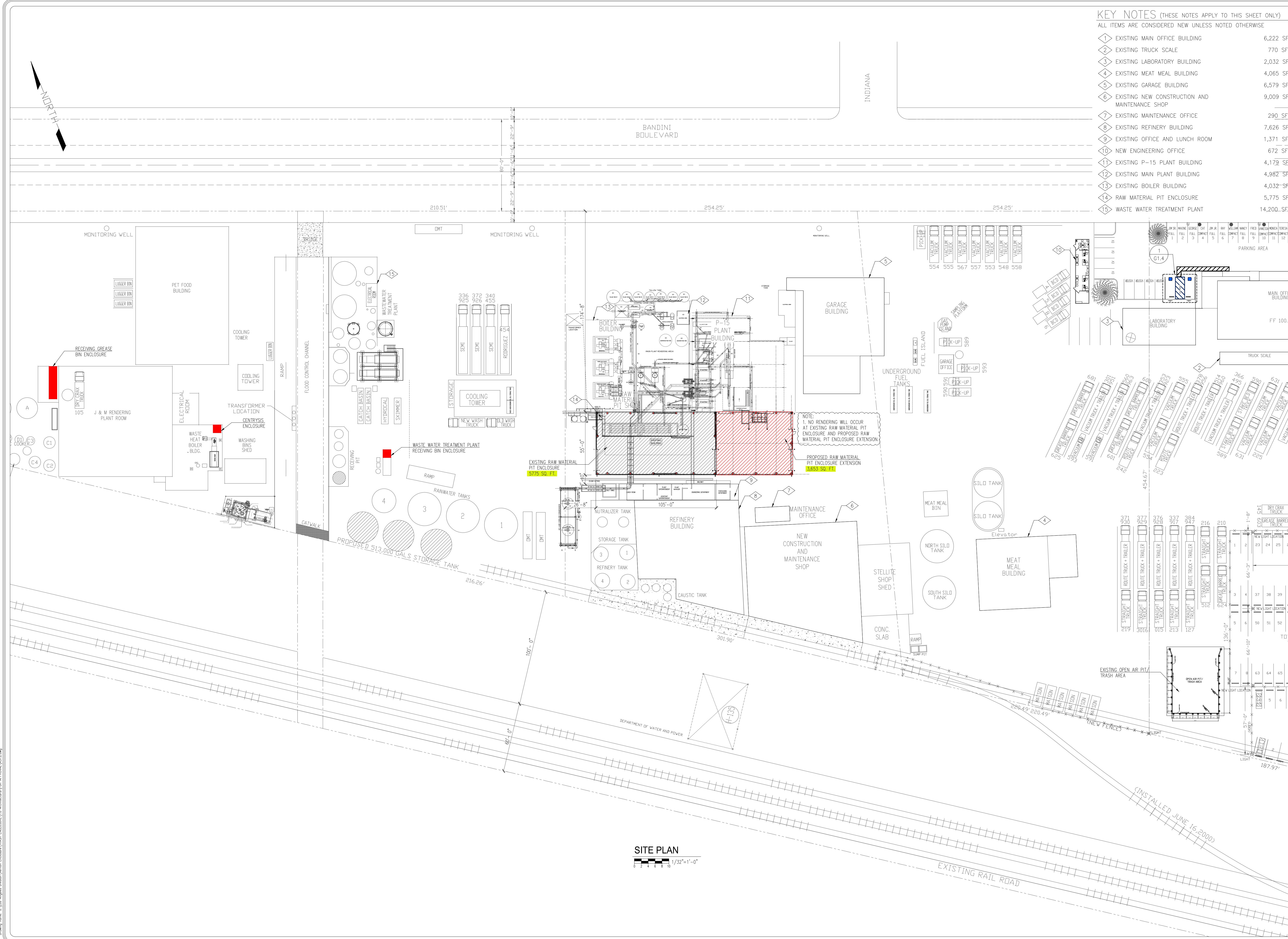

SITE PLAN
1/32"=1'-0"

Drawn name: A:\User\Angela\Drawings\Enclosure\Bldg\ENCLOSURE\1.0_Architectural\FOR_APPROVAL\AS1.2.dwg